

# Bay Tec Center

## FLEX AVAILABILITIES

### April 2024



## 2810 - 2880 Scherer Drive St. Petersburg, FL 33716

SQ. FT.	BLDG.	SUITE	LOADING	OFFICE/WAREHOUSE	CLEAR HEIGHT	LEASE RATE
2,067	2840	420	1 Grade Level	1,938 Office / 129 Warehouse	15'	\$10.95 NNN*
2,688	2840	425	1 Grade Level	1,263 Office / 1,425 Warehouse	15'	\$10.95 NNN*
3,639	2820	200-210	1 Grade Level	2,000 Office / 1,639 Warehouse	15'	\$10.95 NNN*

\*The lease rate is based on a 5 year lease term.

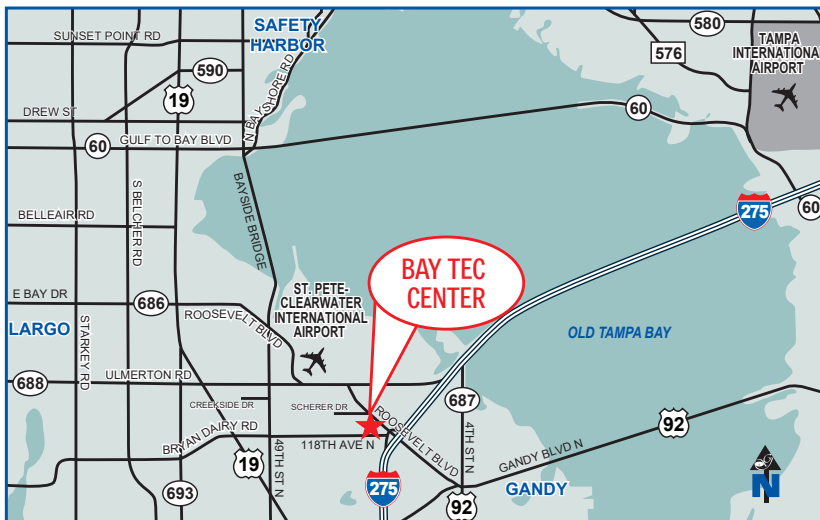

FOR MORE INFORMATION CONTACT:

**CHRISTINA PETTI**

Cell: 813.245.1246

Email: [christina@ipgcommercialrealty.com](mailto:christina@ipgcommercialrealty.com)

**KELLI HATTON**

Cell: 813.454.1619

Email: [kelli@ipgcommercialrealty.com](mailto:kelli@ipgcommercialrealty.com)

**Industrial Property Group, Inc.**

Licensed Real Estate Broker

2202 N. Westshore Blvd. • Suite 200 • Tampa, FL 33607

[www.ipgcommercialrealty.com](http://www.ipgcommercialrealty.com)

Owned and Managed by  
Arden Logistics Parks



No warranty or representation, expressed or implied, is made as to the accuracy of the information contained herein, and same is submitted subject to errors, omissions, change of price, rental or other conditions, withdrawal without notice, and to any special listing conditions imposed by our principals.

# Bay Tec Center

## FLEX AVAILABILITIES

### April 2024

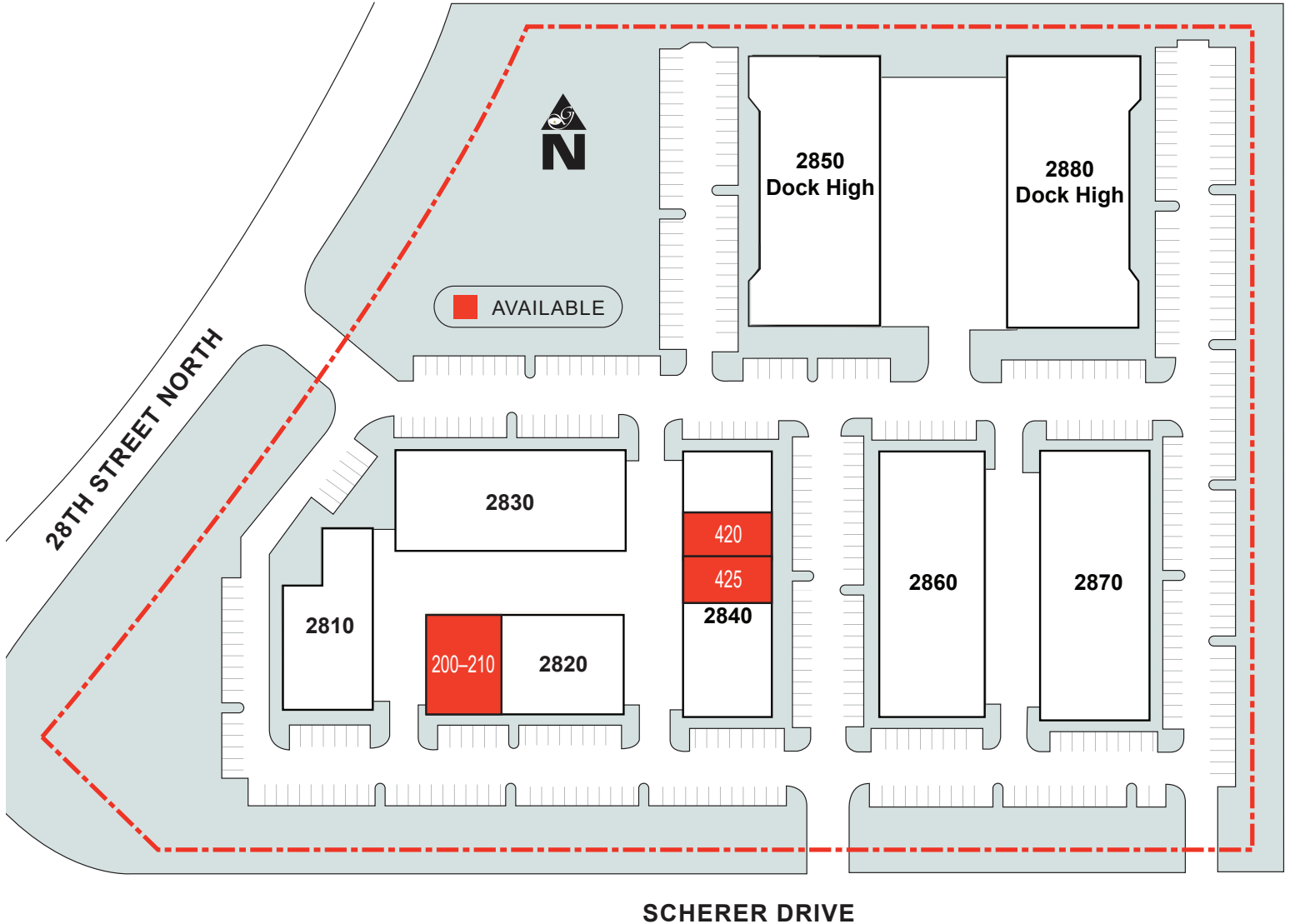

FOR MORE INFORMATION CONTACT:

**CHRISTINA PETTI**

Cell: 813.245.1246 • Email: [christina@ipgcommercialrealty.com](mailto:christina@ipgcommercialrealty.com)

**KELLI HATTON**

Cell: 813.454.1619 • Email: [kelli@ipgcommercialrealty.com](mailto:kelli@ipgcommercialrealty.com)

**Industrial Property Group, Inc.**

Licensed Real Estate Broker

2202 N. Westshore Blvd. • Suite 200 • Tampa, FL 33607

[www.ipgcommercialrealty.com](http://www.ipgcommercialrealty.com)

Owned and Managed by  
**Arden Logistics Parks**

No warranty or representation, expressed or implied, is made as to the accuracy of the information contained herein, and same is submitted subject to errors, omissions, change of price, rental or other conditions, withdrawal without notice, and to any special listing conditions imposed by our principals.